PAPER TITLE: FERROCEMENT: FIVE DECADES OF PROGRESS

Name Author¹, Name Author²...

¹ Author1 (Affiliation, full institutional address and email)

² Author1 (ex: J.P. Dupont, University of California, Burlingame, USA, jpdupont@ferro13.org)

...

SUMMARY: *The instructions put together below fall into three categories. The editor would be grateful to authors for respecting these instructions. The length of this summary should not exceed 10 lines. It is to be written in size 9 italic Times New Roman.*

....

....

....

....

....

....

....

KEY WORDS: *a maximum of six significant words: keyword 1, keyword 2, keyword 3, keyword 4, keyword 5, keyword 6.*

....

....

....

....

....

....

1. INTRODUCTION – USE THE "STYLE TITLE 1"

This extended abstract must be submitted on the website (<https://ferro13.sciencesconf.org/>) before the deadline. The filing format is imperatively PDF (File / Save As / PDF Format).

Body of the text, adopt the NORMAL or CURRENT TEXT style. The **extended abstract** must have a length of **3 pages** including the title page, and using this template. The **full paper** is limited to **10 pages including the title page**, and should only have an even number of pages.

All the texts are to be written in justified Roman Times (Times New Roman on PC) body 10, lowercase, interlaced 12 points exactly, without hyphenation in the text, with a first line paragraph of 5 mm. A space of 6 pts is defined after each paragraph (format> paragraph> space after: 6 pts).

The titles and subtitles are as explained below. In addition, authors who wish to highlight a term can do so using italics or bold, but never underlines.

For the lists, use the style "Enumeration level 1" or "Enumeration level 2".

Standard A4 paper size (210 x 297 mm) should be applied with the following layout and margin characteristics:

- Top margin: 50mm
- Bottom: 65 mm
- Left: 50 mm
- Right: 40 mm

1.1. Use the "Title Level 2 Style"

1.1.1 Use the "Title Level 3 Style"

2. FIGURES AND TABLES

Figures, illustrations and tables should be incorporated into the text. The figures and illustrations are numbered from 1 to n inside the article, as are the tables. Explicit legends accompany them, made up of justified Times body 10, without paragraph, Figure x in bold Roman followed by a bold point, text in lean italics.

For the insertion of figures such as images, please choose the "Image style" style.

3. FORMULAS

The formulas which are the subject of a reference in the text are numbered from (1) to (n) in parenthesis.

$$1 + 1 = 2 \quad (1)$$

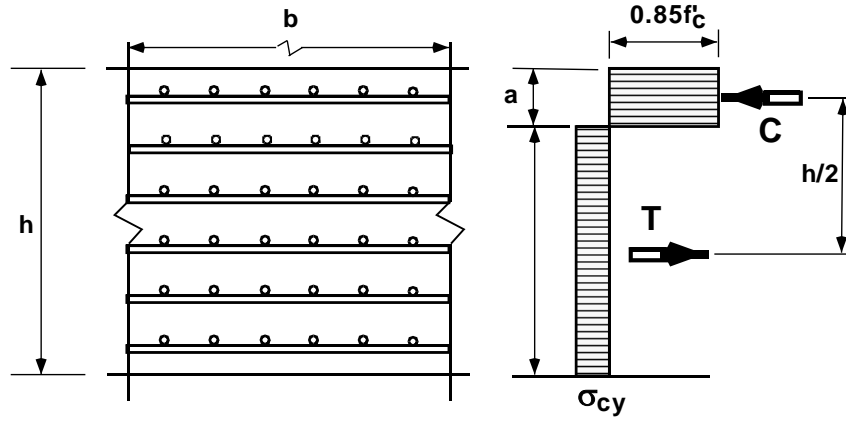

Figure 1. Assumed stress distribution for computation of plastic moment

Tables will use a font size of 10 if possible but not less than size 9.

Table 1. Minimum values of yield strength and effective modulus for steel meshes and bars recommended for design (from ACI 549)

		Woven square mesh	Welded square mesh	Hexagonal mesh	Expanded metal lath	Longitudinal bars
Yield Strength σ_y	MPa	450	450	450	450	450
	(ksi)	(65)	(65)	(65)	(65)	(65)
Effective Modulus E_r	$(E_r)_L$. GP a	138	138	138	138	138
	(10^3 ksi)	(20)	(20)	(20)	(20)	(20)
	$(E_r)_T$. GP a	165	165	165	165	165
	(10^3 ksi)	(24)	(24)	(24)	(24)	(24)

4. REFERENCES

Written in Roman body 9, spaced 11 points, the references are gathered at the end of the article in alphabetical order, spaced apart from each other by 6 points. Their number, of the type [12], is placed in square brackets. Leave two blank spaces before starting the text. They are justified with a 5 mm negative paragraph (Format> Paragraph> Withdrawal of negative 1st line of 0.5 cm).

Here are some examples:

- For the edition (title in italics, the rest in Roman)

[1] KOLSKIC., *Human-machine interfaces*, Paris, Editions Hermès, 1997.

- For published journals and conference proceedings (title of journal or conference in italics, the rest in Roman)

[2] DEMEURE I., FARHAT J., "Light process systems: concepts and examples", *Computer Science and Technology*, vol. 13, n ° 6, 1994, p. 765-795.

[3] LALLOUET A., "DP-LOG: a logical data-parallel language", *Proceedings of the 6th French-speaking days of logical programming and constraint programming JFPLC'97*, Orléans, May 26-28, 1997, Paris, Editions Hermès, p. 53-68.

- For internal reports and theses (text all in Roman):

[4] BRAUN T., DIOT C., HOGLANDER A., ROCA V., An experimental user level implementation of TCP, research report no 265, September 1995, INRIA. [5] NAWROCKI A., Contribution to the modeling of monotoron cables by finite elements, Doctoral thesis, University of Nantes, 1997